



Cheers! Welcome to Best Place!

Best Place is located in the heart of the original Pabst Brewery in downtown Milwaukee. This historic venue boasts two unique event halls located in two buildings dating to the 1800s. Best Place's staff has the professional experience to help people host unforgettable events.

Look no further for the "Best Place" for your event! We frequently host wedding ceremonies and receptions, holiday, anniversary, birthday, and retirement parties, corporate seminars, lectures, workshops, and meetings, nonprofit fundraisers, bridal and baby showers, celebrations of life, and so much more.

"As a catering company and as event planners, our clients frequently ask us to recommend a place to hold their events. Best Place at the Historic Pabst Brewery has joined the top of our list as a captivating and historic venue for professional and social occasions."

-Saz's Catering

"I see this as a unique venue where Old World charm and a contemporary style combine to make any event a memory. It's a caterers dream and a host's dream-come-true!"

- Scott Shully, Shully's Cuisine and Events

Best Place is a small, family-run business that is built on the foundation of honoring the legacy that Jacob Best started in 1844, and that Frederick Pabst continued into the twentieth century. We meticulously care for these historic landmarks, maintaining them for future generations to enjoy. Our event team cares for each of our clients unique needs with the same spirit, maintaining our reputation as one of the BEST wedding venues in the country!

- Jim & Karen Haertel ♦ Owners and Chief Stewards

www.bestplacemilwaukee.com
917 W Juneau Ave. ♦ Milwaukee, WI 53233
Sarah Grissmeyer ♦ 414-614-0172 ♦ bestplaceevents@gmail.com
Cheryl Komp ♦ 414-217-5794 ♦ pbrme@ymail.com
Mark Yancheske ♦ 414-403-8413 ♦ bestplaceevents.inquiries@gmail.com



The Great Hall & Speakeasy

Built in 1880 and renovated in 2014, The Great Hall was the original corporate headquarters of the Pabst Brewery. This space includes Frederick Pabst's original office, the prohibition-themed "Speakeasy" bar, original stained glass windows, a back bar built in 1890, ornate woodwork, and cream city brick exterior.

The Great Hall:

Seated Capacity: 250 people

Square Footage: 4800

Room Dimensions: 60' x 80'

Ceiling Height: 18'

Dance Floor: 25' x 25' (Or more!)

Head Table: Up to 16 people

Bridal Suite: Included

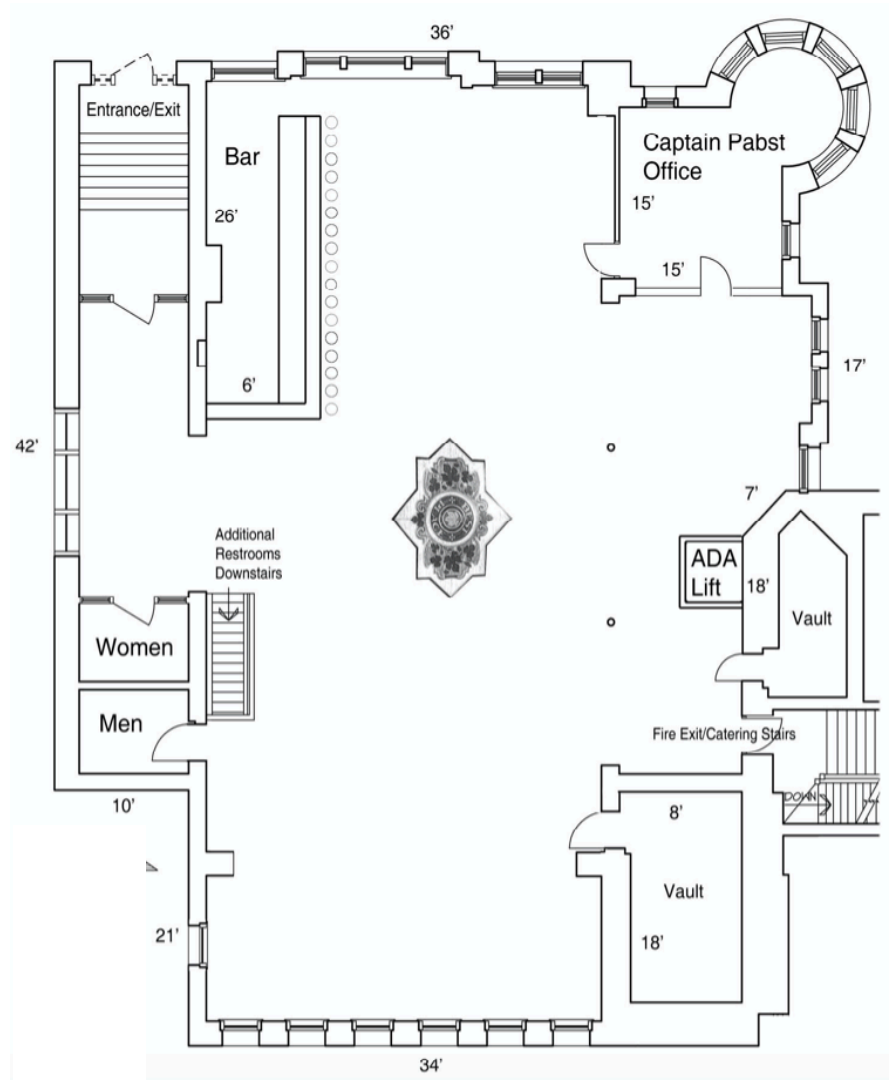

The Great Hall - 923 W Juneau Ave.

www.bestplacemilwaukee.com
917 W Juneau Ave. ♦ Milwaukee, WI 53233
Sarah Grissmeyer ♦ 414-614-0172 ♦ bestplaceevents@gmail.com
Cheryl Komp ♦ 414-217-5794 ♦ pbrme@ymail.com
Mark Yenceske ♦ 414-403-8413 ♦ bestplaceevents.inquiries@gmail.com



Blue Ribbon Hall & The Captain's Courtyard

Step back in time as you enter Blue Ribbon Hall, the corporate VIP center of the historic Pabst Brewery. This German beer hall-style space comes complete with an outdoor courtyard that we call "Captain's Courtyard", a second-story balcony, hand-painted fresco murals, iron chandeliers, hand-blown glass windows, and hand-carved decorative wood trim.

Blue Ribbon Hall:

Seated Capacity: 140 people

Square Footage: 2000

Room Dimensions: 40' x 50'

Ceiling Height: 14'

Dance Floor: 25' x 25'

Head Table: Up to 12 people

Captain's Courtyard:

Seated Capacity: 120 people

Square Footage: 1350

Room Dimensions: 30' x 40'

Ceiling Height: Open Air

Dance Floor: 25' x 25'

www.bestplacemilwaukee.com
917 W Juneau Ave. ♦ Milwaukee, WI 53233
Sarah Grissmeyer ♦ 414-614-0172 ♦ bestplaceevents@gmail.com
Cheryl Komp ♦ 414-217-5794 ♦ pbrme@ymail.com
Mark Yancheske ♦ 414-403-8413 ♦ bestplaceevents.inquiries@gmail.com

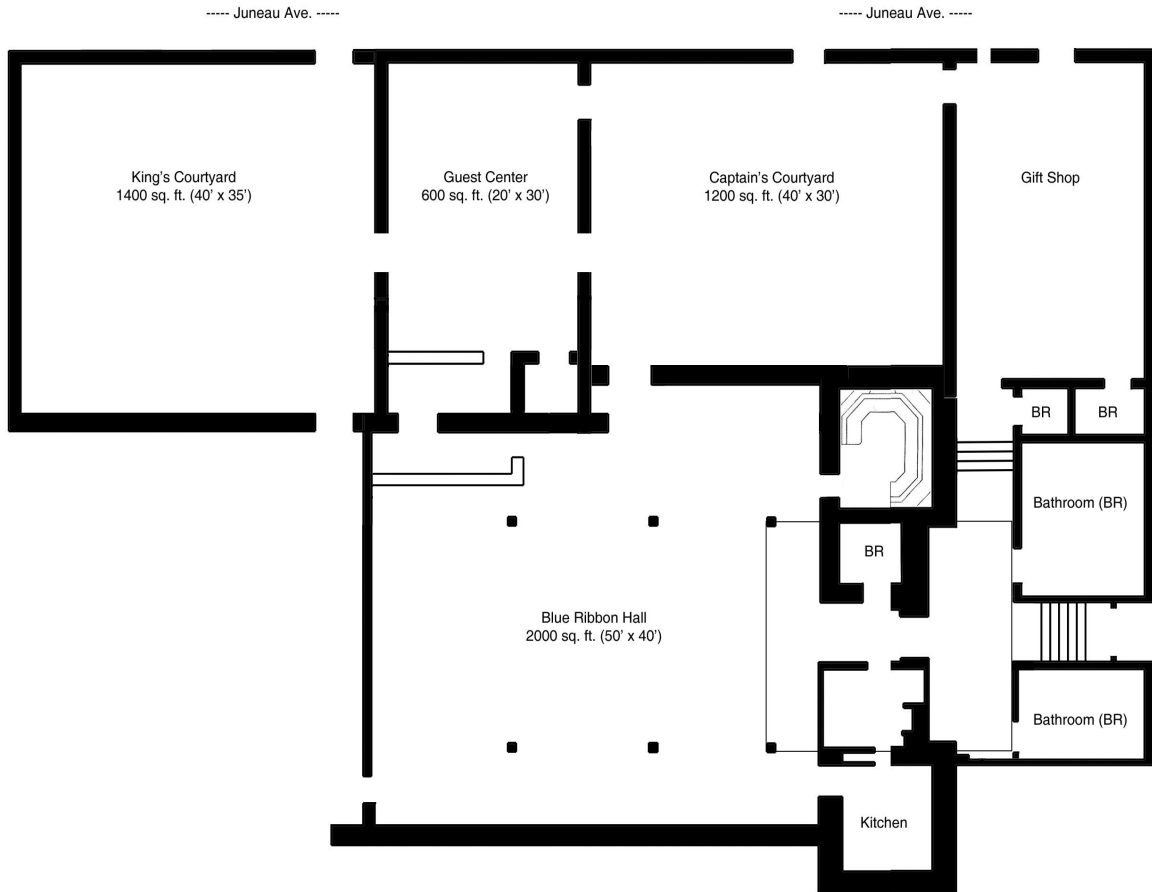

Blue Ribbon Hall & Related Areas

Scale: 1/16" = 1'-0"

Blue Ribbon Hall - 907 W Juneau Ave.

www.bestplacemilwaukee.com
917 W Juneau Ave. ♦ Milwaukee, WI 53233
Sarah Grissmeyer ♦ 414-614-0172 ♦ bestplaceevents@gmail.com
Cheryl Komp ♦ 414-217-5794 ♦ pbrme@ymail.com
Mark Yancheske ♦ 414-403-8413 ♦ bestplaceevents.inquiries@gmail.com



Rental Rates and Price Information

Please contact our team for current rental rates. Our rental fee includes more than most venues: tables and chairs, full bar capability, bartenders, water station, room setup and cleaning*, A/V, projector, screen, microphones, podiums, and the historic event spaces themselves.

Add-Ons (Optional):

Additional Hours - \$500.00 per hour Monday - Thursday, \$1000.00 per hour Friday - Sunday
Ceremony fee - \$500.00 with room rental, \$500.00 per hour of occupancy without room rental
Beer History Tour - \$100.00 per special tour request
Stage rental - \$100.00

Additional Charges (Required):

Sales Tax - 5.5% applied to room fee, add-ons, and bar bills
Gratuuity - 18% on any hosted bar bill
Saturday rates apply for Holiday weekend events

Beverage Information

We have very reasonable beverage pricing, and we don't have rigid drink packages. We like to let you customize a bar package for your event. We prefer to simply charge for each beverage you wish to host, up to a maximum amount, with tip, that you are comfortable with ahead of time. When events host beer, wine, and soft drinks, the price per person averages about \$25. When cocktails are added to that, the average price per person goes up to about \$40 for rail (Absolut, Tanqueray, Bacardi, Jose Cuervo, Seagrams 7, and Christian Brothers brandy) and about \$60 for a full open bar including premium/top shelf liquors. We do not have a minimum purchase requirement for private event rentals.

\$2.00 - Bottled Water and Soda (Coke products)
\$3.00 - Sprecher Root Beer, Juice, and Non-alcoholic Pabst
\$4.00 - Pabst, Schlitz, Old Milwaukee, and other domestics
\$5.00 - Hard Seltzers including White Claw and others
\$6.00 - Craft Beer including Lakefront, Central Waters, and other Wisconsin breweries
\$6.00 - \$9.00 - Wine selections including Cabernet, Merlot, Pinot Noir, Chardonnay, Sauvignon Blanc, Pinot Grigio, Prosecco, Riesling, and Rose.
\$7.00 - 12.00 - Mixed Drink and Spirit selections

**Pricing is subject to change based on market conditions

www.bestplacemilwaukee.com
917 W Juneau Ave. ♦ Milwaukee, WI 53233
Sarah Grissmeyer ♦ 414-614-0172 ♦ bestplaceevents@gmail.com
Cheryl Komp ♦ 414-217-5794 ♦ pbrme@ymail.com
Mark Yenceske ♦ 414-403-8413 ♦ bestplaceevents.inquiries@gmail.com



HOTELS & LODGING

The Brewhouse Inn & Suites | Across the Street - 1215 N 10th St., Milwaukee, WI 53205
Hyatt Place Downtown Milwaukee | 1 Block - 800 W. Juneau Ave., Milwaukee, WI 53233
The Aloft Hotel | 6 Blocks - 1230 Old World 3rd St., Milwaukee, WI 53203
Hyatt Regency Milwaukee | 9 Blocks - 333 W. Kilbourn Ave., Milwaukee, WI 53203
DoubleTree by Hilton Hotel | 6 Blocks - 611 W. Wisconsin Avenue, Milwaukee, WI, 53203
Hilton Milwaukee City Center | 7 Blocks - 509 W. Wisconsin Ave., Milwaukee, WI 53203
InterContinental Milwaukee | 12 Blocks - 139 E. Kilbourn Ave., Milwaukee, WI 53202
Iron Horse Hotel | 1 mile - 500 W. Florida St., Milwaukee, WI 53204
The Pfister Hotel | 1 mile - 424 East Wisconsin Avenue, Milwaukee, WI 53202
Drury Plaza Hotel Milwaukee Downtown | 1 mile - 700 North Water Street, Milwaukee, WI 53202

LOCAL ATTRACTIONS

Best Place Beery History Tour - Best Place Gift Shop - 917 W Juneau Ave. Milwaukee WI 53233
Discovery World at Pier Wisconsin | 2 Miles - 500 N. Harbor Dr., Milwaukee, WI 53203
Fiserv Forum | 3 Blocks - 1111 Vel R. Phillips Ave., Milwaukee, WI 53203
Harley-Davidson Museum | 10 Blocks - 400 W. Canal St., Milwaukee, WI 53201
Marcus Center for the Performing Arts | 6 Blocks - 929 N. Water St., Milwaukee, WI 53202
American Family Field | 3 Miles - 201 South 46th Street, Milwaukee, WI 53214
Milwaukee Art Museum | 2 Miles - 750 North Lincoln Memorial Drive, Milwaukee, WI 53202
Milwaukee County Zoo | 6 Miles - 10001 West Bluemound Road, Milwaukee, WI 53226
Milwaukee Public Market | 10 Blocks - 400 N. Water St., Milwaukee WI 53202
Milwaukee Public Museum | 6 Blocks - 800 West Wells Street, Milwaukee, WI 53233
Milwaukee Repertory Theater | 6 Blocks - 108 E. Wells St., Milwaukee, WI 53202
Milwaukee Riverwalk | 6 Blocks - Downtown Milwaukee
The Domes | 2 Miles - 524 S. Layton Blvd., Milwaukee, WI 53215
Old World 3rd St. | 6 Blocks - Old World 3rd St., Milwaukee, WI 53202
Pabst Mansion | 1 Mile - 2000 West Wisconsin Avenue, Milwaukee, WI 53233
Potawatomi Bingo Casino | 2 Miles - 1721 W. Canal St., Milwaukee, WI 53233

www.bestplacemilwaukee.com
917 W Juneau Ave. ♦ Milwaukee, WI 53233
Sarah Grissmeyer ♦ 414-614-0172 ♦ bestplaceevents@gmail.com
Cheryl Komp ♦ 414-217-5794 ♦ pbrme@ymail.com
Mark Yenceske ♦ 414-403-8413 ♦ bestplaceevents.inquiries@gmail.com



Approved Event Caterers

	Contact	Phone	Website
Antigua	Citlali Menieta	414-321-5775	antiguamilwaukee.com
Beans & Barley Catering	Jennifer Yandow	414-278-7878	beansandbarley.com
Chef Jack's Catering	Candy Curly	262-549-5558	chefjacks.com
Davian's Catering	Andi Salmon	262-781-8507	davians.com
Irene's Catering	Mark Vicena	414-645-4469	irenescatering.com
Mader's Creative Cuisine	Kathleen Weber	414-271-3377 X224	madersrestaurant.com
Black Shoe Catering (Maxie's / Blues Egg)	Heather Shea	414-336-1005	blackshoehospitality.com
Prime Minister Catering	Tim	262-238-1530	pmcatering.com
Red Lion	Sandy Gillespie	414-469-9409	redlionpubmke.com
Saz's Catering	Matt Hawkins	414-256-8765	sazs.com
Shully's Cuisine	Nina Darling	262-242-6633	shullyscuisine.com
Smoke Shack Catering	Nicki	414-585-8934	smoke-shack.com/catering
Tall Guy and a Grill Catering	Brit Grosenick	414-777-0770	tallguyandagrill.com
Zilli's Hospitality	Todd Garvens	414-278-6997 262-547-9447	zillihospitalitygroup.com

www.bestplacemilwaukee.com
 917 W Juneau Ave. ♦ Milwaukee, WI 53233
 Sarah Grissmeyer ♦ 414-614-0172 ♦ bestplaceevents@gmail.com
 Cheryl Komp ♦ 414-217-5794 ♦ pbrme@ymail.com
 Mark Yancheske ♦ 414-403-8413 ♦ bestplaceevents.inquiries@gmail.com



Suggested Vendors

Photographers	Contat	Phone	Website
Front Room Photography	Shannon Richmond	414-294-0080	frphotowedding.com
George Street Photo & Video	Emma Perry	866-831-4103	georgestreetphoto.com
Holen Photography	Dan Holen		holenphotography.com
M Three Studio Photography	Molly Micheael	262-497-7246	mthreestudioblog.com
Paul Bialas Photography	Paul Bialas	414-704-5600	lakecountyphoto.com
Reminisce Studio	Miranda Kneeland	414-405-6693	capturingyourday.com
SB Photography and Design	Adam Aten	414-220-0022	sbphotoanddesign.com
Twin Lens Weddings	Sarah Moore	414-628-4773	twinlenswedding.com
Vital Image Studio	Tasha Motto	262-292-9000	vitalimage.com
Florists			
Bank of Memories & Flowers	Melissa Maas	262-253-9111	bankofflowers.net
Bloom Floral & Event Design	Laurel Flannery	414-731-4265	blsoomlovely.com
Feisty Flowers	Jaclyn Millonzi	414-526-5202	feistyflowers.com
French Poodle Floral	Cindy Davis	414-379-1977	frenchpoodlefloral.com
Milwaukee Flower Company	Sally Vander-Wyst	414-899-1395	milwaukeeflowerco.com
Bakery			
Aggie's Cakes & Pasteries	Rachel Schmidbauer	414-482-1288	aggiescakes.com
Extra Special Touch Bakery	Diane Wisnieski	262-542-5801	testbakery.com
Gigi's Cupcakes	Larry Lechner	414-777-7465	gigiscupcakesusa.com
The Cake Lady	Cecelia Baker-Grade	414-294-4220	cakeladydesigns.com

www.bestplacemilwaukee.com
 917 W Juneau Ave. ♦ Milwaukee, WI 53233
 Sarah Grissmeyer ♦ 414-614-0172 ♦ bestplaceevents@gmail.com
 Cheryl Komp ♦ 414-217-5794 ♦ pbrme@ymail.com
 Mark Yenceske ♦ 414-403-8413 ♦ bestplaceevents.inquiries@gmail.com



Suggested Vendors Continued

Party Rentals	Contact	Phone	Website
Arena Rentals		414-831-7000	arenaamericas.com
Brookfield Party Rentals	Debbie Martinucci	262-786-2666	madfoxparty.com
Canopies	Doug	414-760-0770	canopiesevents.com
Windy City Linen	Tera Stam	224-279-1500	windycitylinen.com
BBJ Linen	Lindsay Wolf-Kacala	414-355-9010	bbjlinen.com
Wedding Planning			
Dare to Dream Weddings	Megan Potter	414-232-4391	daretodreamweddingswi.com
Events to a T	Tiara Gomez	262-914-9661	eventstoatmke.com
Blue Fancy Events	Meredith	414-376-3414	bluefancyevents.com
Timeless Events	Kristin Wroblewski	262-751-6355	milwaukeeeventplanning.com
DJ's			
A Personal Touch	Matt Collins	262-510-5061	apersonaltouchdj.net
Acoustic Generation	Matt or Linsea	847-477-5257	theacoustingeneration.com
Milwaukee Airwaves	Kendrick Acken	414-306-8273	milwaukeeairwaves.com
That DJ Entertainment	Joe Grenz	414-269-8500	thatdjentertainment.com
Officiant			
Connie Horvath		262-689-5162	
Judge Derek Mosely		(414) 286-8759	derek.mosley@milwaukee.gov
Other			
Bianca Bridal Boutique (Gowns/Tuxs)	Kelly Lahti	262-251-5400	biancabridalbtq.com
City Tours MKE (Shuttle Services)	Meghan Miles	414-712-8690	citytoursmke.com
Jewelry Works (Custom Wedding Jewelry)	Michael Eubank	262-377-9010	

www.bestplacemilwaukee.com
 917 W Juneau Ave. ♦ Milwaukee, WI 53233
 Sarah Grissmeyer ♦ 414-614-0172 ♦ bestplaceevents@gmail.com
 Cheryl Komp ♦ 414-217-5794 ♦ pbrme@ymail.com
 Mark Yancheske ♦ 414-403-8413 ♦ bestplaceevents.inquiries@gmail.com



Frequently Asked Questions

Is a deposit required?

Yes, a deposit of 25% is required to secure a date immediately. The full balance is due 30 days prior to the event.

How early can we get into the venue?

Typically between 2-2:30pm, though depending on the circumstances we may be able to offer earlier entry.

When can we drop off decorations?

We allow drop-offs the day prior to the event.

When do we have to be cleared out?

We won't boot you out the door when your event ends, though we do ask that you leave within one hour of the end of the contracted event.

Can we pick up decoration the next day?

Yes, if decorations are packed up in boxes after an event, you can come back the next morning to pick them up.

Is the venue ADA compliant?

Yes, we are fully ADA compliant. Passageways are 33" wide or more, restrooms are ADA compliant, and the elevator lift is 39" x 60".

What is your cancellation policy?

We are happy to postpone events rather than cancel. A sample contract is available upon request.

Are there bar minimums or bar packages?

No, our bar operates on a consumption basis.

We don't have a required minimum purchase, and we don't have rigid drink packages. We like to let you customize a bar package for your event. We can give you examples and a better explanation of a consumption based package upon request.

How many bartenders will you staff?

We staff one bartender per 50 guests.

www.bestplacemilwaukee.com
917 W Juneau Ave. ♦ Milwaukee, WI 53233
Sarah Grissmeyer ♦ 414-614-0172 ♦ bestplaceevents@gmail.com
Cheryl Komp ♦ 414-217-5794 ♦ pbrme@ymail.com
Mark Yenceske ♦ 414-403-8413 ♦ bestplaceevents.inquiries@gmail.com



Frequently Asked Questions Continued

Is there an on-site caterer?

We do not have an in-house caterer, but we do have an approved list of caterers that we love to work with.

How far in advance must we book your services?

We suggest as soon as possible, we're not a very well kept secret anymore.

Do you provide a sound system or A/V?

Yes, we can provide microphones, HD projector and screen, and a house sound system.

Are there restrictions on decorations?

Preserving the historic buildings is important to us, we ask that our clients respect the history of the venue. Items are not to be placed on the walls or hung from the ceilings (we suggest the use of easels which we can provide). All displays located within Best Place cannot be changed or removed. The use of glitter, confetti, sequins, sequins-confetti or tinsel is prohibited. Tape, nails, tacks & staples are prohibited. Only enclosed candles are permitted. Fogging and bubble machines are not allowed. No candles, glass vases nor lanterns are allowed on the floor.

What is the parking situation for guests?

There is street parking available in front of the venue and in the surrounding Brewery District neighborhood. There is also a parking garage across the street managed by Interstate Parking, you can reserve spaces with that company.

Is there a hotel nearby?

Yes, there are two hotels close to Best Place. The Brewhouse Inn & Suites, and Hyatt Place Downtown are both located within one block of Best Place.

Could other events be scheduled the same day?

Yes, we do have beer history tours but they will not conflict with any hall rental situation. There also may be another event in a different venue.

www.bestplacemilwaukee.com
917 W Juneau Ave. ♦ Milwaukee, WI 53233
Sarah Grissmeyer ♦ 414-614-0172 ♦ bestplaceevents@gmail.com
Cheryl Komp ♦ 414-217-5794 ♦ pbrme@ymail.com
Mark Yancheske ♦ 414-403-8413 ♦ bestplaceevents.inquiries@gmail.com
